

Product data sheet

Characteristics

NSYSFPSC80

Post fixing device WM Spacial, length 800. For post max 675. Max. Load:100kg.

Product availability : Non-Stock - Not normally stocked in distribution facility



Price* : 165.34 USD

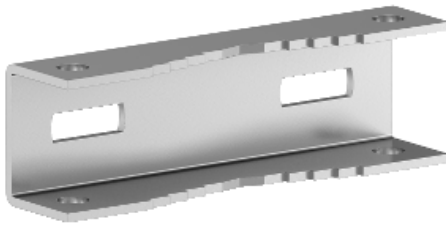

Main

Range	Spacial
Accessory / separate part category	Fixing accessory
Product or component type	Post fixing device
Application	Multi-purpose
For enclosure nominal dimensions	-
Mounting location	Rear of enclosure
Range compatibility	Spacial CRN Spacial S3D Spacial SBM
Device composition	2 x support rail 2 x strip Fixing elements
Quantity per set	Set of 1

Complementary

Material	Galvanised steel
Fixing mode	Minimum diameter 150 mm Maximum diameter 215 mm By fixing element - screw type M8 - to the inserts in the rear of the enclosure location
Permanent permissible load	220.46 lb(US) (100 kg)
Height	1.77 in (45 mm)
Width	31.3 in (795 mm)
Depth	1.28 in (32.5 mm)
Product weight	8.82 lb(US) (4 kg)

Ordering and shipping details

Category	80036 - ENCLOSURE SYSTEMS ACCESSORIES
----------	---------------------------------------

Discount Schedule	ES1
GTIN	003606480198908
Nbr. of units in pkg.	1
Package weight(Lbs)	8.800000000000007
Returnability	N
Country of origin	ES

Offer Sustainability

Sustainable offer status	Green Premium product
RoHS (date code: YYWW)	Compliant - since 0940 - Schneider Electric declaration of conformity Schneider Electric declaration of conformity
REACH	Reference not containing SVHC above the threshold Reference not containing SVHC above the threshold
Product environmental profile	Available
Product end of life instructions	Need no specific recycling operations
California proposition 65	WARNING: Cancer and Reproductive Harm - www.P65Warnings.ca.gov

Contractual warranty

Warranty period	18 months
-----------------	-----------