

Product data sheet

Specifications

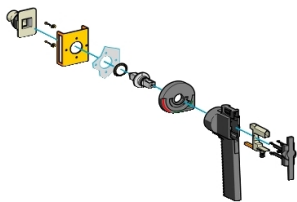

rotary handle front GS1 - 630...1250 A - black handle

GS1AH150

! Discontinued

Main

Range Of Product	TeSys GS
Device Short Name	GS1 handle
Product Or Component Type	Handle
Product Compatibility	Switch disconnecter 630...1250 A
Type Of Operating Handle	External
Mounting Location	Front
Handle Colour	Black

Complementary

Handle Front Plate Colour	Black
Rotary Handle Padlocking	With
Net Weight	15432.37 lb(US) (7000 kg)

Environment

Ip Degree Of Protection	IP65
-------------------------	------

Ordering and shipping details

Category	22640-IEC DISCONNECT-GS1,LK3
Discount Schedule	I11
Gtin	00785901367574
Returnability	No
Country Of Origin	FR

Contractual warranty

Warranty	18 months
----------	-----------

Price is "List Price" and may be subject to a trade discount – check with your local distributor or retailer for actual price.

Sustainability

Green Premium™ label is Schneider Electric's commitment to delivering products with best-in-class environmental performance. Green Premium promises compliance with the latest regulations, transparency on environmental impacts, as well as circular and low-CO₂ products.

Guide to assessing product sustainability is a white paper that clarifies global eco-label standards and how to interpret environmental declarations.

[Learn more about Green Premium >](#)

[Guide to assess a product's sustainability >](#)

California Proposition 65

WARNING: This product can expose you to chemicals including: Antimony oxide & Antimony trioxide, which is known to the State of California to cause cancer. Bisphenol A (BPA), which is known to the State of California to cause birth defects or other reproductive harm. For more information go to www.p65warnings.ca.gov
