

Product data sheet

Specifications

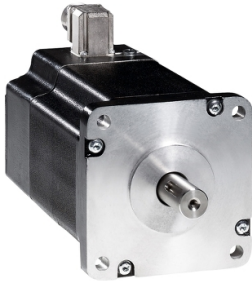

3-phase stepper motor - 13.5Nm - shaft \varnothing 19mm - L=180mm - w/o brake - connector

BRS3ACW850ACA

Product availability: Non-Stock - Not normally stocked in distribution facility

Price*: 940.00 USD

Main

Range Compatibility	Lexium SD3
Product Or Component Type	Motion control motor
Device Short Name	BRS3
Maximum Mechanical Speed	3000 rpm
Motor Type	3-phase stepper motor
Number Of Motor Poles	6
Supply Voltage Limits	230 V AC 325 V DC
Mounting Support	Flange
Motor Flange Size	4.33 in (110 mm)
Length	7.09 in (180 mm)
Centring Collar Diameter	2.20 in (56 mm)

Complementary

Centring Collar Depth	0.12 in (3 mm)
Number Of Mounting Holes	4
Mounting Holes Diameter	0.35 in (9 mm)
Circle Diameter Of The Mounting Holes	4.96 in (125.86 mm)
Electrical Connection	Connector
Holding Brake	Without
Shaft End	Parallel key
Second Shaft	Without second shaft end
Shaft Diameter	0.75 in (19 mm)
Shaft Length	1.57 in (40 mm)
Nominal Torque	106.21 lbf.in (12 N.m)
Peak Stall Torque	101.08 lbf.in (11.42 N.m)
Continuous Stall Torque	101.08 lbf.in (11.42 N.m)
Holding Torque	119.48 lbf.in (13.5 N.m)
Rotor Inertia	10.5 kg.cm²

Price is "List Price" and may be subject to a trade discount – check with your local distributor or retailer for actual price.

Disclaimer: This documentation is not intended as a substitute for and is not to be used for determining suitability or reliability of these products for specific user applications

Resolution	1.8 °, 0.9 °, 0.72 °, 0.36 °, 0.18 °, 0.09 °, 0.072 °, 0.036 ° step angle 200, 400, 500, 1000, 2000, 4000, 5000, 10000 steps number of full steps per revolution
Accuracy Error	+/- 6 arc min
Maximum Starting Frequency	4.7 kHz
Line Rated Current	4.1 A
Resistance	1.8 Ohm winding)
Time Constant	22 ms
Maximum Radial Force Fr	150 N second shaft end) 300 N first shaft end)
Maximum Axial Force Fa	330 N tensile force) 60 N force pressure)
Service Life In Hours	20000 h bearing)
Angular Acceleration	200000 rad/s²
Net Weight	18.08 lb(US) (8.2 kg)

Environment

Standards	IEC 60072-1 IEC 50347
Type Of Cooling	Natural convection
Ambient Air Temperature For Operation	-13...104 °F (-25...40 °C)
Ambient Air Temperature For Storage	-13...158 °F (-25...70 °C)
Operating Altitude	<= 3280.84 ft (1000 m) without power derating
Relative Humidity	15...85 % without condensation
Vibration Resistance	20 m/s² maximum A IEC 60034-14
Ip Degree Of Protection	IP41 shaft bushing: conforming to IEC 60034-5 IP56 total except shaft bushing: conforming to IEC 60034-5
Temperature Class	F winding IEC 60034-1

Ordering and shipping details

Category	US1PC5518284
Discount Schedule	PC55
Gtin	3389119224178
Returnability	No
Country Of Origin	US

Packing Units

Unit Type Of Package 1	PCE
Number Of Units In Package 1	1
Package 1 Height	9.06 in (23.0 cm)
Package 1 Width	7.87 in (20.0 cm)
Package 1 Length	15.75 in (40.0 cm)
Package 1 Weight	20.00 lb(US) (9.07 kg)
Unit Type Of Package 2	P06

Number Of Units In Package 2	12
Package 2 Height	30.31 in (77.0 cm)
Package 2 Width	31.50 in (80.0 cm)
Package 2 Length	23.62 in (60.0 cm)
Package 2 Weight	258.69 lb(US) (117.34 kg)

Contractual warranty

Warranty	18 months
----------	-----------

Sustainability



Green Premium™ label is Schneider Electric’s commitment to delivering products with best-in-class environmental performance. Green Premium promises compliance with the latest regulations, transparency on environmental impacts, as well as circular and low-CO₂ products.

Guide to assessing product sustainability is a white paper that clarifies global eco-label standards and how to interpret environmental declarations.

[Learn more about Green Premium >](#)

[Guide to assess a product’s sustainability >](#)



Transparency RoHS/REACH

Well-being performance

✓ Mercury Free

✓ Rohs Exemption Information [Yes](#)

✓ Pvc Free

Certifications & Standards

Reach Regulation	REACH Declaration
Eu Rohs Directive	Pro-active compliance (Product out of EU RoHS legal scope)
China Rohs Regulation	China RoHS declaration
Environmental Disclosure	Product Environmental Profile
Weee	The product must be disposed on European Union markets following specific waste collection and never end up in rubbish bins.
Circularity Profile	No need of specific recycling operations
California Proposition 65	WARNING: This product can expose you to chemicals including: Lead and lead compounds, which is known to the State of California to cause cancer and birth defects or other reproductive harm. For more information go to www.P65Warnings.ca.gov

Dimensions Drawings

Dimensions

3-Phase Stepper Motor in Connector Version

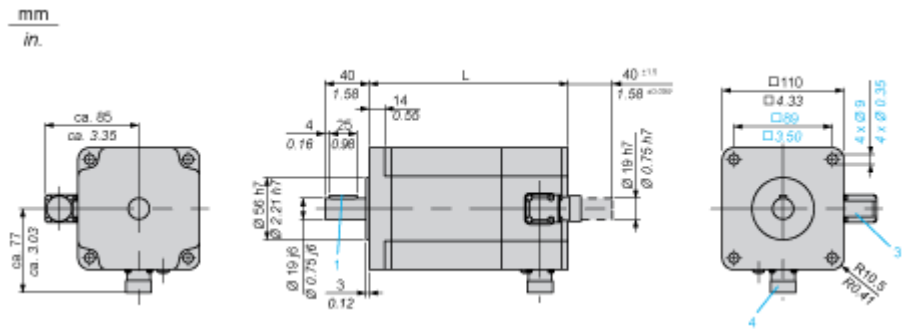

- 3 : Plug connection encoder (optional) 12 poles
- 4 : Plug connection motor 6 poles

Dimensions in mm

L	Parallel key DIN 6885 (1)
180 ±1	6 x 6 x 25

Dimensions in in.

L	Parallel key DIN 6885 (1)
7.09 ±0.039	0.24 x 0.24 x 0.98

Performance Curves

Torque Characteristics

Measurement at 1000 Steps/Revolution, Nominal Voltage DC Bus U_N and Phase Current I_N

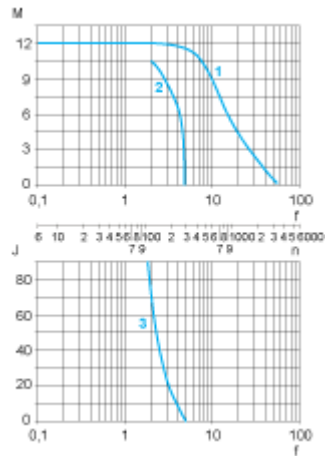

- M : Torque in Nm
- n : Speed in rpm
- f : Frequency in kHz
- J : Rotor inertia in $\text{kg}\cdot\text{cm}^2$
- 1 : Pull-out torque
- 2 : Pull-in torque
- 3 : Maximum load inertia