

Product availability : Non-Stock - Not normally stocked in distribution facility



Price\* : 5.28 USD



### Main

Range of product	Harmony 9001K
Accessory / separate part type	Legend plate
Accessory / separate part category	Marking accessory
Accessory / separate part destination	Control and signalling units Ø 30 mm (metal range)
Label dimensions	44 x 50 mm
Marking	White PULL TO START/PUSH TO STOP on black background
Language	English

### Complementary

Mounting diameter	1.18 in (30 mm)
Material	Aluminium
Product weight	0.01 lb(US) (0.005 kg)

### Ordering and shipping details

Category	21433 - 9001 ACCESS FOR K,KX,SK
Discount Schedule	CS1
GTIN	00785901042402
Nbr. of units in pkg.	50
Package weight(Lbs)	0.01
Returnability	N
Country of origin	US

### Offer Sustainability

RoHS (date code: YYWW)	Compliant <a href="#">Schneider Electric declaration of conformity</a>
REACH	Reference not containing SVHC above the threshold

Reference not containing SVHC above the threshold

California proposition 65	WARNING: This product can expose you to chemicals including:
----- Substance 1	Nickel compounds, which is known to the State of California to cause cancer, and
----- Substance 2	Di-isodecyl phthalate (DIDP), which is known to the State of California to cause birth defects or other reproductive harm.
----- More information	For more information go to <a href="http://www.p65warnings.ca.gov">www.p65warnings.ca.gov</a>

Contractual warranty

Warranty period	18 months
-----------------	-----------

Dimensions

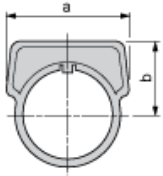

a		b	
mm	in.	mm	in.
44.5	1.75	31.4	1.24