

Product data sheet

Specifications

SQUARE D



30mm Push Button, Type K, aluminum legend plate, black, marked START

9001KN201

Product availability: Stock - Normally stocked in distribution facility

Price*: 5.28 USD

Main

Range Of Product	Harmony 9001K Harmony 9001SK
Product Or Component Type	Marked legend
Accessory / Separate Part Type	Legend plate
Accessory / Separate Part Category	Marking accessory
Accessory / Separate Part Destination	Control and signalling units Ø 30 mm (metal range)
Label Dimensions	40 x 43 mm
Marking	White START black
User Language	English

Complementary

Mounting Diameter	1.18 in (30 mm)
Material	Aluminium
Net Weight	0.01 lb(US) (0.005 kg)
Size	30 mm
Colour Of Marking	Silver
Background Colour	Black
Marking	START

Ordering and shipping details

Category	US10CS121433
Discount Schedule	0CS1
Gtin	785901915102
Returnability	Yes
Country Of Origin	MX

Packing Units

Unit Type Of Package 1	PCE
Number Of Units In Package 1	1
Package 1 Height	0.10 in (0.254 cm)
Package 1 Width	1.70 in (4.318 cm)

Price is "List Price" and may be subject to a trade discount – check with your local distributor or retailer for actual price.

Disclaimer: This documentation is not intended as a substitute for and is not to be used for determining suitability or reliability of these products for specific user applications

Package 1 Length	1.70 in (4.318 cm)
Package 1 Weight	0.16 oz (4.536 g)
Unit Type Of Package 2	BB1
Number Of Units In Package 2	50
Package 2 Height	2.28 in (5.8 cm)
Package 2 Width	2.17 in (5.5 cm)
Package 2 Length	3.70 in (9.4 cm)
Package 2 Weight	8.01 oz (227.0 g)

Contractual warranty

Warranty	18 months
----------	-----------

Sustainability



Green Premium™ label is Schneider Electric's commitment to delivering products with best-in-class environmental performance. Green Premium promises compliance with the latest regulations, transparency on environmental impacts, as well as circular and low-CO₂ products.

Guide to assessing product sustainability is a white paper that clarifies global eco-label standards and how to interpret environmental declarations.

[Learn more about Green Premium >](#)

[Guide to assess a product's sustainability >](#)

Well-being performance

 Mercury Free	
 Rohs Exemption Information	Yes
Reach Regulation	REACH Declaration
Eu Rohs Directive	Pro-active compliance (Product out of EU RoHS legal scope)
China Rohs Regulation	China RoHS declaration
California Proposition 65	WARNING: This product can expose you to chemicals including: Nickel compounds, which is known to the State of California to cause cancer, and Di-isodecyl phthalate (DIDP), which is known to the State of California to cause birth defects or other reproductive harm. For more information go to www.P65Warnings.ca.gov

Dimensions Drawings

Dimensions

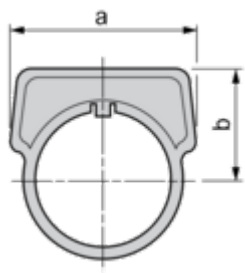

a		b	
mm	in.	mm	in.
41.3	1.62	24.6	0.97